

ALUMÍNIO

PERFIS TUBOS QUADRADOS

TUBOS QUADRADOS

CÓDIGO	PESO (kg/m)	DESCRIÇÃO (tubo)	PÁGINA
TQ-006	0,244 kg	Tubo quadrado de 19,05 x 19,05mm	01
TQ-009	0,329 kg	Tubo quadrado de 25,4 x 25,4mm	01
TQ-017	0,650 kg	Tubo quadrado de 50,8 x 50,8mm	01
TUG-100	2,016 kg	Tubo quadrado de 101,6 x 101,6mm	01

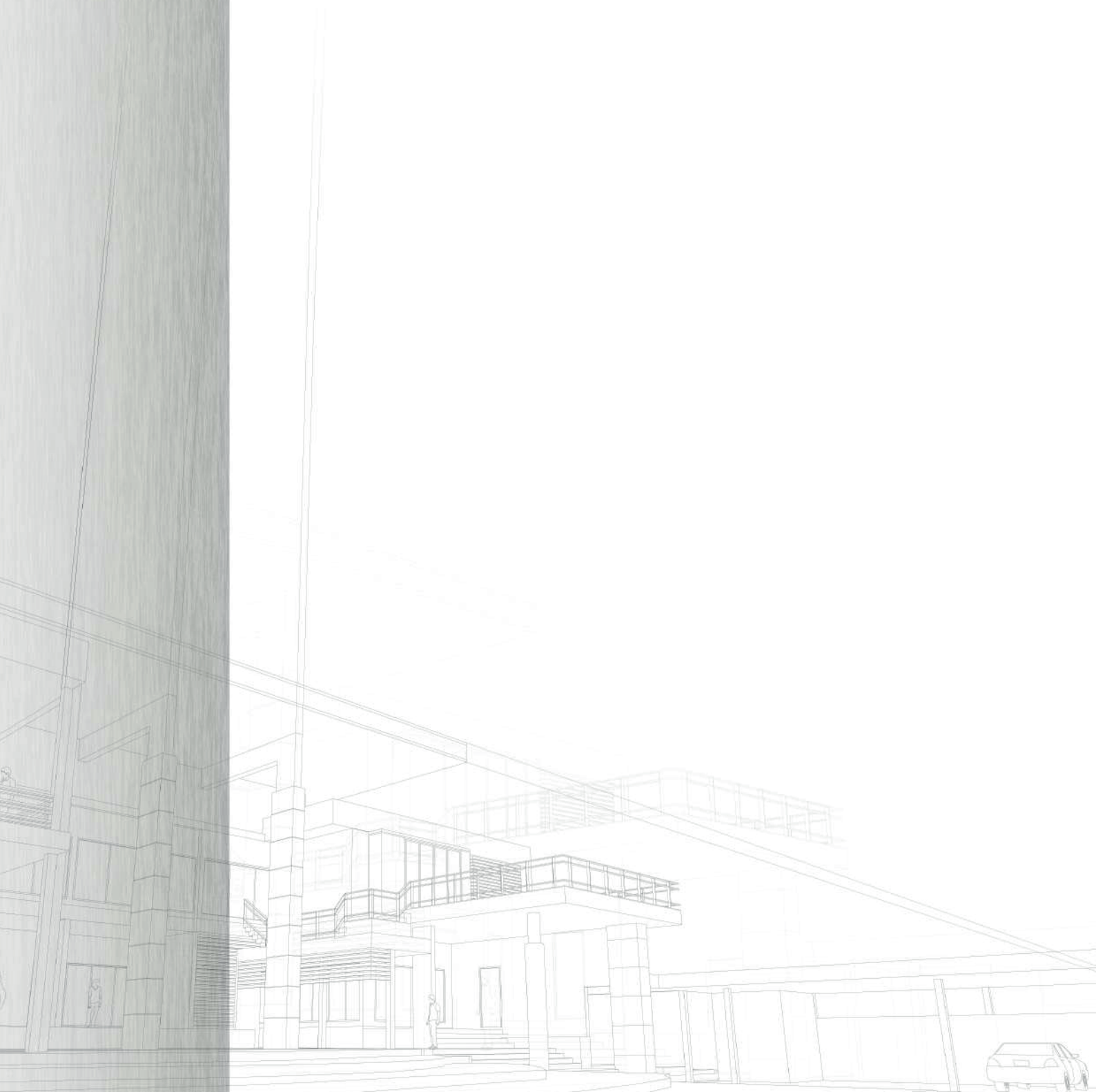

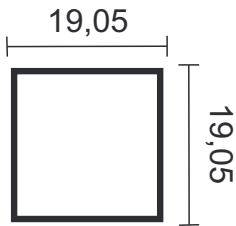

Cód. Poliformas	Peso (kg/m)
TQ-006	0,244

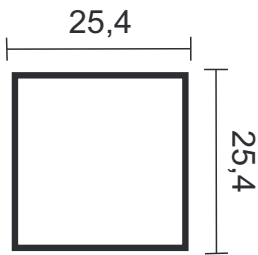

Cód. Poliformas	Peso (kg/m)
TQ-009	0,329

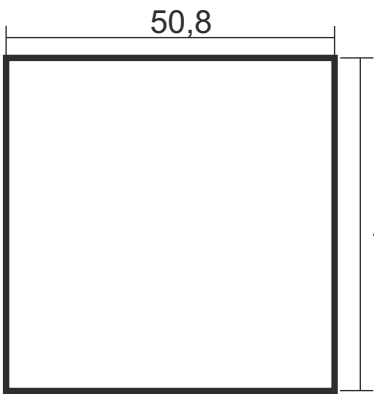

Cód. Poliformas	Peso (kg/m)
TUG-017	0,650

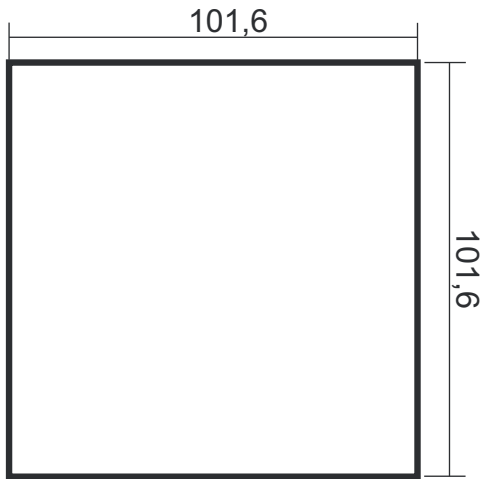

Cód. Poliformas	Peso (kg/m)
TUG-100	2,016